

**ADDENDUM NO. 3**

November 1, 2022

**RE: Component 4 & 6: Liquid Transloading Facility - Civil, Structural and Fire Suppression Site Work at Facility One**

**FROM:** Tina Perkins, Construction Administrator  
Toledo – Lucas County Port Authority  
One Maritime Plaza  
Toledo, Ohio 43604-1866  
Website: toledoport.org  
P: (419)243-8251

**TO:** Plan Holders

This Addendum forms a part of the Contract Documents and modifies the original Procurement Documents, as noted below. **Acknowledge receipt of this Addendum in the space provided on the Form Proposal.** Failure to do so may subject Bidder to disqualification.

**BID DOCUMENT CLARIFICATION**

1. The Bid Opening remains scheduled for Tuesday, November 8, 2022, at 1:00 pm., via conference call. (SEE BELOW)

TIME AND PLACE FOR RECEIPT OF PROPOSALS

- Sealed bids will be received at the Port Authority's administrative office, 1st floor reception area at One Maritime Plaza, Toledo, OH 43604 until Tuesday, November 8, 2022, at 1:00 pm. Bids will be read aloud via conference call and the standard public bid opening procedures will be followed.

CONFERENCE CALL LINE

- The conference call line number for those that wish to hear the bids be publicly opened and read aloud is:  
Conference Call No.: (866) 252-0050  
Participant Code No.: 5156208#

2. Drawing MT-101-3005 (SEE ATTACHED)
  - Partial Site Plan: Foam House Area – Revised

3. Form of Proposal – Revised – (SEE ATTACHED)
  - Alternate Bid 1 – GIS - ADDED
    - Item A1-0001 – Provide GIS Information
  - Miscellaneous Bid Item – Added
    - Ref. No. 015 - Allowance – \$25,000 for underground obstructions that interfere with completion of project.
4. Davis Bacon Wage Rate Decision Number: OH20220088 09/30/2022 – (SEE ATTACHED)
  - Added **ONLY** for Sprinkler Fitter – (Fire Sprinklers) classification.

### PREBID QUESTIONS AND ANSWERS:

1. **Question:** On sheet MT-101-4006 Section view “C-C”
  - a. Is this the correction section for the dike?  
**Answer:** Yes, this is the correct section.
  - b. Is a keyway required for the dike?  
**Answer:** No keyway is required for the dike.
  - c. In referencing the Geo Technical Report, Section 4.3 and 5.10, it is not clear that there is enough acceptable material onsite to construct dike.
    - I. Is there enough material onsite to construction the Containment Dike?  
**Answer:** Per drawing MT-101-4001, there is expected to be a net deficit, requiring fill. Midwest Terminals can confirm if there is additional suitable fill on site.
    - II. What are the Permeability requirements?  
**Answer:** There are no permeability requirements.
    - III. Do you anticipate material will need to be imported?  
**Answer:** No, we anticipate this to be a balance site, if needed Owner will provide.
2. **Question:** On sheet C3, note 2 (bottom right), it says the contractor to determine if existing subgrade material is sufficient as backfill and if not suitable shall replace existing stone with granular engineered backfill. As a contractor, are we responsible for any undercutting of subgrade? If so, can you provide an estimate quantity? Can you add an undercutting bid item?  
  
**Answer:** A \$25,000 allowance has been included on the revised Form of Proposal. This allowance is to be used only for the identified purpose(s) and/or as deemed suitable by TLCPA. Balance of allowance fund at the end of the project will be credited back to the project.
3. **Question:** What do you want to do with STM 120 located in the new rail spur location?  
  
**Answer:** STM 120 is to be removed. The contractor shall verify that the structure does not have any pipes entering or leaving it.

4. **Question:** Why is the piping system from the railroad off load to the detention basin in the civil package when steel pipe is a mechanical item? Can we use DIP?

**Answer:** DIP can be substituted if contactor can assure equal length.

5. **Question:** Can you please provide specification requirements for the liner used in the containment ditch along with pipe penetration requirements?

**Answer:** HDPE geomembrane liner, US resistant, 40 mil minimum thickness.

6. **Question:** What day is NTP anticipated?

**Answer:** We anticipate awarding this project shortly after bid review and approval by TLCPA Board of Directors and all grant agencies. A notice to proceed will be issued following contract completion.

7. **Question:** ITP #23 states bidders required to hold its bid prices up to a maximum of 180 calendar days, most vendors aren't honoring quotes outside of 14 days, can the decision time be reduced to account for market volatility?

**Answer:** We anticipate awarding this project shortly after review and approval by TLCPA Board of Directors and all grant agencies. To ensure a timely review of by grant agencies, all necessary and required supporting documents should be provided in proposals. Failure to do so may result in delay during the review process.

8. **Question:** It's stated that Contractor will receive payment within 15 days of Owners receipt of funds. What is the anticipated time for Owner to received payment of monthly progress payment?

**Answer:** TLCPA will process monthly project pay applications within 30 days of receipt.

9. **Question:** Page 136 of specs state Contractor to work 5 days a week, 10 HRs per day, M-F. Will a 4 each 10 hours per day work week be acceptable or any other work windows to overtime acceptable?

**Answer:** Any work outside of normal weekday hours should be coordinated with Midwest Terminals.

10. **Question:** Are removed concrete & wooden ties to be included with the rail material that is to be stockpiled on site?

**Answer:** Yes.

11. **Question:** What material is desired for ballast, (granite, trap rock, or limestone)?

**Answer:** Rail ballast material will be reused from another project onsite and will be provided by the owner.

12. **Question:** New RMB frogs listed, in order to comply with the Buy America, lead times can be up to a year.

a. Will relay frogs be accepted as these are more readily available?

**Answer:** Yes, American relay frogs will be accepted.

b. Will SMSG new or relay frogs be accepted?

**Answer:** RBM frogs are preferred.

13. **Question:** Is there a DBE Goal on this project?

**Answer:** This project has a 5% EDGE goal. Contractors are expected to put forth a good faith effort to meet this goal. If you cannot meet the goal, you are required to complete the Good Faith Affidavit located in the bid documents. Per contract documents and prior to contract execution a request for waiver will be required from the contractor.

14. **Question:** Drawing MT-101-5503 “Structural plan rail offload area sections” and NARSTCO drawing conflict for the ballast section. How wide is ballast to be placed under the tracks and at what depth beneath the tie?

**Answer:** Manufacturer recommended.

15. **Question:** What is the stationing for loading areas on the 3 tracks requiring bonding and grounding?

**Answer:** Refer to rail length on drawing.

16. **Question:** Are insulated joints desired with the bonding and grounding?

**Answer:** Six (6), loading stations need to be bonded and grounded.

17. **Question:** Please clarify the scope of work between drawings for the Foam House on JDRM Drawing ED2 and MT-101-3005. Underground layout with J-boxes is different between the two drawings. Does the scope stop at the J-boxes?

**Answer:** Please utilize MT-101-3005 updated 10/24/22 for clarification of the underground conduit path from the cable tray to the Foam Building and disregard the routing on JDRM drawing E-2. There will be no J-boxes near the cable tray.

For specification of the J-boxes and installation from the boxes into the Foam Building, utilize JDRM E-2.

Please note that the power conduit should be a 3" (P-126) and the Communications Conduit should be 2" (D-302) and should be sized similarly from the J-boxes to the Foam Building.

18. **Question:** Davis Bacon wage rates do not include a Sprinkler Fitter category; can this be added by an addendum?

**Answer:** General Decision Number: OH20220088 9/30/2022, has been added to the contract **ONLY** to be used for Sprinkler Fitter – (Fire Sprinklers).

**END OF ADDENDUM NO. 3**

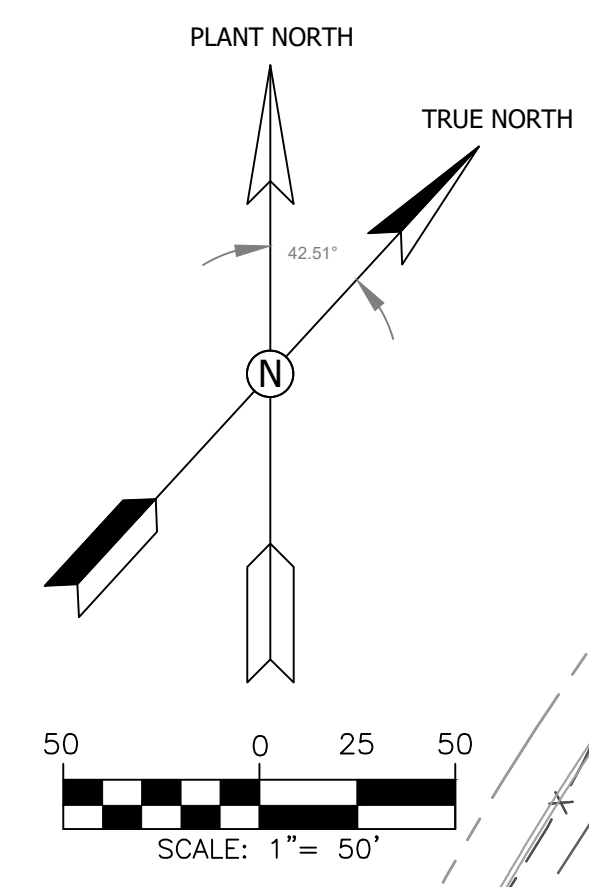
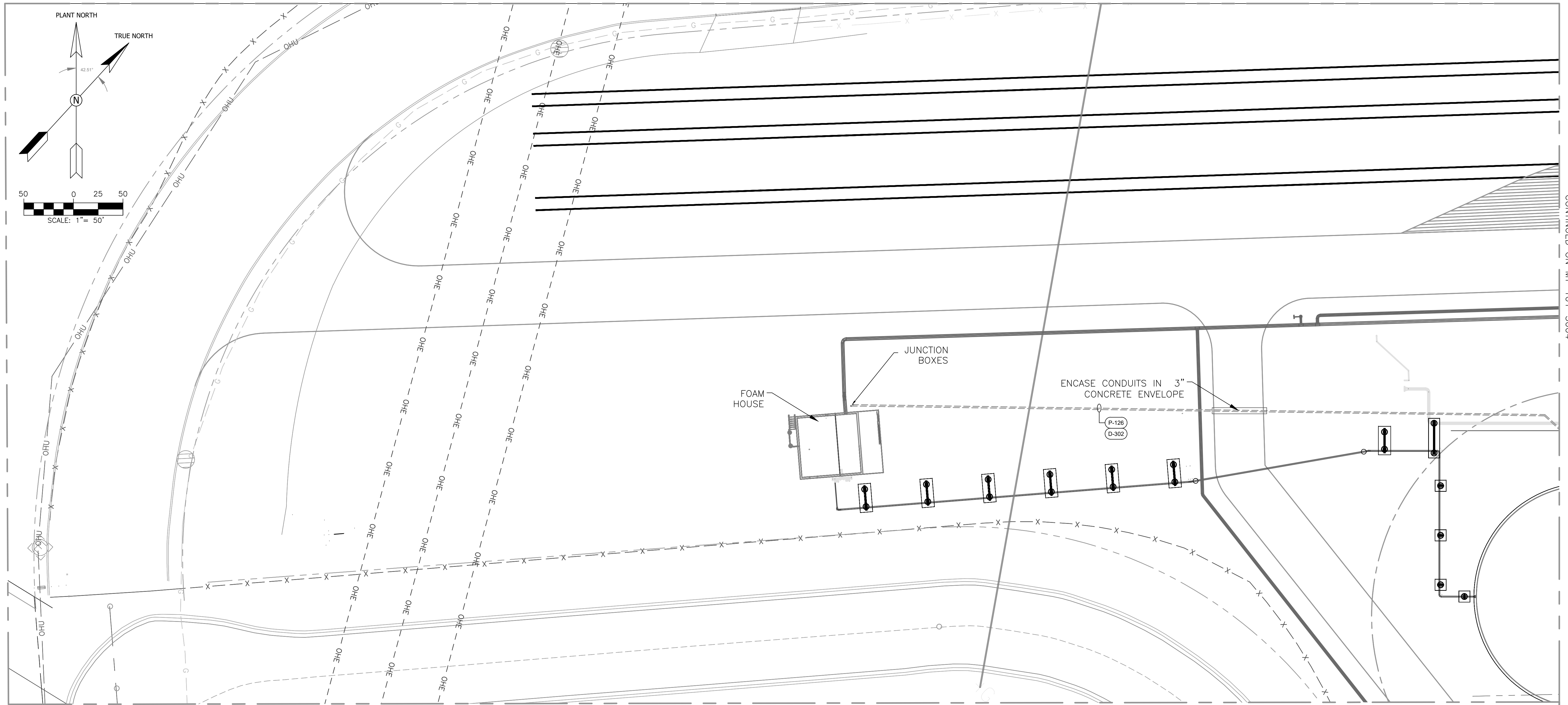

FILE: O:\FILE\_SERVER\MIDWEST\_TERMINAL\TOLEDO PLANT\_3D PROJECT\ORTHOS\DWGS\022896\ELECTRICAL\MT-101-3005 - LAYOUT1 - PLOT.DWG - FOAM HOUSE.DWG - LAYOUT1 - PLOT DATE: 10/24/2022 4:33 PM BY: GENE TEGENKAMP - LAST SAVED DATE: 10/24/2022 4:28 PM  
 CONTINUED ON MT-101-3004

B1	UPDATED FOR BID NOT FOR CONSTRUCTION	GMT	9/16/2022
B	ISSUED FOR BID NOT FOR CONSTRUCTION	GMT	9/16/2022
A1	ISSUED FOR REVIEW NOT FOR CONSTRUCTION	GMT	11/22/2021
NO.	REVISIONS	BY	DATE

**NOTES**

1. PLACE TAPE AND TRACE WIRE 12" ABOVE ALL UNDERGROUND CONDUITS.
2. ALL UNDERGROUND CONDUITS MUST BE AT LEAST 12" AWAY FROM UNDERGROUND PIPE.

**REFERENCE DRAWINGS**

- |             |                           |
|-------------|---------------------------|
| MT-101-3900 | CONDUIT SCHEDULE (POWER)  |
| MT-101-3905 | CONDUIT SCHEDULE (120VAC) |
| MT-101-3910 | CONDUIT SCHEDULE (24VDC)  |

**UPDATED FOR  
 BID  
 10/24/2022**

**RIDGE & ASSOCIATES, INC.**  
 CONSULTING ENGINEERS  
 P.O. BOX 1091  
 FINDLAY, OHIO 45839

© 2020, RIDGE & ASSOCIATES, INC.  
 ALL RIGHTS RESERVED. THIS DRAWING CONTAINS  
 CONFIDENTIAL AND PROPRIETARY INFORMATION.

MIDWEST TERMINALS FACILITY 1 ELECTRICAL			
DATE	10/24/2022	ADDRESS	3518 ST. LAWRENCE DRIVE
DRN	GMT	CDD	KEM
APVD	K. MILLER		SCALE
TITLE	<b>PARTIAL SITE PLAN: FOAM HOUSE AREA</b>		MT-101-3005

ENGINEER'S STAMP

**FORM OF PROPOSAL**

NOTES 1: The wording of this Proposal shall be retained throughout, without change, alterations or additions. Any change in the wording may cause the Proposal to be rejected as not complying with the law.

NOTES 2: The form of Proposal shall be accompanied by a properly secured Proposal Bond or certified check in a specific amount (STATED IN DOLLARS AND CENTS) not less than ten percent (10%) of the total of the sum of sums bid on all items of the Proposal. Non-compliance with these requirements may cause a Proposal to be rejected.

**PROPOSAL**

TO: Toledo-Lucas County Port Authority  
One Maritime Plaza  
Toledo, OH 43604

Submitted by: \_\_\_\_\_ on \_\_\_\_\_, 20\_\_.

Having read the Bid documents and having examined the specifications entitled:

**Component's 4 & 6: Liquid Transloading Facility  
Civil, Structural and Fire Suppression Site Work  
Facility One - 3518 St. Lawrence Dr., Toledo, Ohio 43605**

prepared by the Toledo-Lucas County Port Authority for the Component's 4 & 6: Liquid Transloading Facility Civil, Structural and Fire Suppression Site Work, project located at Facility One, 3518 St. Lawrence Dr., Toledo, Ohio 43605 and having also received, read and taken into account Addenda Nos.

\_\_\_\_\_ and likewise having inspected the Project Site and the conditions affecting and governing the removal of said items, the undersigned hereby proposes to furnish all equipment and to perform all labor as specified and described in the said specifications for the said work, for the following sum:

(continued on next page)

REF. NO.	WORK ITEM DESCRIPTION	QTY	UNIT	UNIT PRICE	AMOUNT
<b>BASE BID COMPONENTS 4 &amp; 6</b>					
<b>GENERAL</b>					
001	General Conditions	1	LS		
002	Mobilization/Demobilization	1	LS		
<b>CIVIL</b>					
003	Civil, per plan	1	LS		
<b>STRUCTURAL</b>					
004	Structural, per plan	1	LS		
<b>FIRE SUPPRESSION</b>					
005	Fire Suppression, per plan	1	LS		
<b>RAIL</b>					
006	Removal and on-site relocation of Biodiesel Track Materials, per plan	1	LS		
007	Rail, per plan, including installation and freight costs	1	LS		
008	Narstco M10 steel ties, per plan including installation and freight costs	1	LS		
009	Turnouts, including frog and switchpoints for two #8 switches, per plan including installation and freight costs	1	LS		
010	Narstco M10 turnout tie package for two #8 tie packages, per plan including installation and freight costs	1	LS		
011	Narstco 10' road crossing ties, per plan including installation and freight costs	1	LS		
012	Omega Industries concrete road crossings, per plan including installation and freight costs	1	LS		
013	Ballast, per plan including installation and freight costs	1	LS		
014	Rail Stops: Nolan CS50, per plan including installation and freight costs	1	LS		
<b>MISCELLANEOUS</b>					
015	Allowance - Underground obstructions that interfere with completion of project	1	LS	\$25,000.00	\$25,000.00
	<i>Note: Allowance is to be used only for the identified puposes(s) and/or as deemed suitable to TLCPA. Balance of allowance funds at the end of the project will be credited back to the project.</i>				
<b>TOTAL BASE BID</b>					
<b>Lump Sum Total for Base Bid in writing:</b>					



REF. NO.	WORK ITEM DESCRIPTION	QTY	UNIT	UNIT PRICE	AMOUNT
<b>ALTERNATE BID 1 - GIS</b>					
<b>GENERAL</b>					
A1-0001	Provide GIS information for all underground utilities installed.	1	LS		
<b>TOTAL ALTERNATE BID 1 - GIS</b>					
<p><b>Lump Sum Total for Alternate Bid 1 - GIS in writing:</b></p> <hr/> <hr/>					

This proposal is made with full knowledge of and in compliance with the Revised Code of the State of Ohio and Rules and Regulations of the Toledo-Lucas County Port Authority.

\_\_\_\_\_  
Bidder

List here full names of every person or  
Company interested in this bid:

By: \_\_\_\_\_

\_\_\_\_\_

Title: \_\_\_\_\_

\_\_\_\_\_

Address: \_\_\_\_\_

\_\_\_\_\_

\_\_\_\_\_

\_\_\_\_\_

Date: \_\_\_\_\_











